

052577

RECEIVED
LARAMIE COUNTY
CHEYENNE, WY.

CERTIFIED LAND CORNER RECORDATION '88 DEC 23 AM 9 08

DESCRIPTION OF CORNER EVIDENCE FOUND, AND ORIGINAL RECORD (If known)

20
29

1/4 Corner Sections 20, 29, T.14N., R. 66 W., 6th P.M.,
Laramie County, Wyoming. Found P-K nail and confirmed by
2 existing references as noted by John Steil, L.S. 2500
Corner Recordation Form.

DESCRIPTION OF MONUMENT AND ACCESSORIES ESTABLISHED
TO PERPETUATE THE ORIGINAL LOCATION OF THIS CORNER:

See ties below

SKETCH, WITH COURSE AND DISTANCE TO ADJACENT CORNER IF DETERMINED IN THIS SURVEY.
(May Sketch or Paste Reproduction on Reverse Side.)

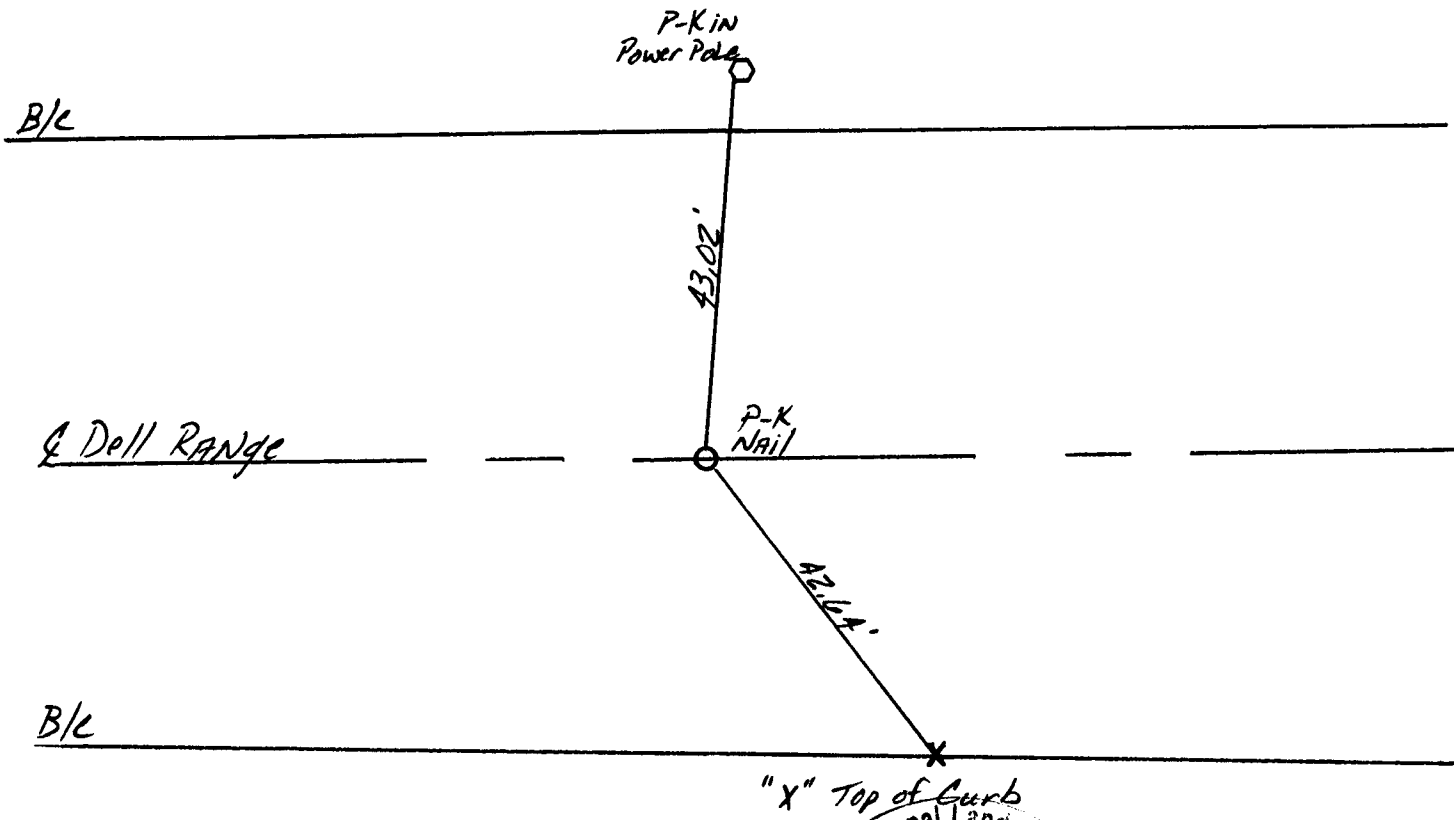

I, BECKY J. BRAMAN certify that I have carefully performed or reviewed the work
done on the diagrammed corner as reported on this recordation form and approve the same.

Becky J. Braman PLS 3881
Signature of Surveyor Registration No.

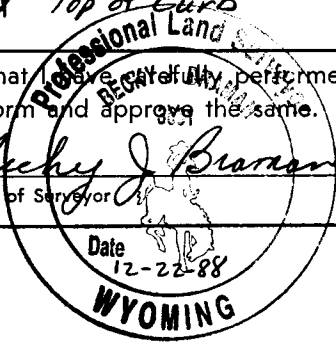

STATE OF WYOMING,
Office of Clerk and Recorder,
County of _____

This "corner record" was filed for record on the _____ day of _____, 19____, was noted
on the cross-index plat and is assigned page No. _____, in book No. _____.

County Official			
Cross Index No. <u>B 7</u>	T. <u>14N</u>	R. <u>66W</u>	Mer.
_____	T. _____	R. _____	Mer.
_____	T. _____	R. <u>*</u>	Mer.
_____	T. _____	R. _____	Mer.
_____	T. _____	R. _____	Mer.
_____	T. _____	R. _____	Mer.
_____	T. _____	R. _____	Mer.